

MICRO SWITCH

## KH-9012



### CLASSIFICATION

KH - 9012 - 5 HLL  
 ①    ②    ③

① TYPE NUMBER	9012	Micro switch Type V	Micro switch Type V
② CONTACT RATING	NONE	125VAC, 15A (Resistance load)	
	5	125VAC, 5A (Resistance load)	
③ ACTUATOR	PB	Pin plunger	
	HL	Short hinge lever	
	HLL	Long hinge lever	
	HLR	Hinge lever Round type	
	HRL	Long hinge roller lever	
	HRM	Hinge roller lever	
	HRS	Short hinge roller lever	

Rated Voltage	Resistive Load				Inductive Load				Motor Load			
	KH-9012-5		KH-9012		KH-9012-5		KH-9012		KH-9012-5		KH-9012	
	NC	NO	NC	NO	NC	NO	NC	NO	NC	NO	NC	NO
125VAC	5A	5A	15A	15A	3A	3A	10A	10A	1.5A	0.7A	4A	2A
250VAC	3A	3A	10A	10A	2A	2A	5A	5A	1.0A	0.5A	2.5A	1.2A
8VDC	5A	5A	15A	15A	3A	3A	10A	10A	-	-	-	-
14VDC	5A	5A	15A	15A	3A	3A	8A	8A	-	-	-	-
30VDC	5A	5A	6A	6A	3A	3A	4A	4A	-	-	-	-
125VDC	0.6A	0.6A	0.6A	0.6A	0.1A	0.1A	0.3A	0.3A	-	-	-	-
250VDC	0.3A	0.3A	0.3A	0.3A	0.05A	0.05A	0.1A	0.1A	-	-	-	-

Model	Model	OF Max.	PT Max	MD Max.	OT min.	OP	Material
KH-9012-5PBC		250g	1.6 mm	1.0 mm	0.3 mm	14.7 mm ± 0.7	Enclosure: PBT glass
KH-9012-5HLC		250g	1.6 mm	0.8 mm	0.3 mm	15.3 mm ± 0.6	Enclosure: PBT glass Lever: Stainless steel
KH-9012-5HLLC		150g	4.0 mm	1.6 mm	0.6 mm	15.3 mm ± 1.6	Enclosure: PBT glass Lever: Stainless steel
KH-9012-5HRLC		150g	4.0 mm	1.6 mm	0.6 mm	20.7 mm ± 1.6	Enclosure: PBT glass Lever: Stainless steel Roller: Brass(Ni plated)
KH-9012-5HRMC		150g	4.0 mm	1.6 mm	0.6 mm	20.6 mm ± 1.6	Enclosure: PBT glass Lever: Stainless steel Roller: Brass(Ni plated)
KH-9012-5HRSC		250g	1.6 mm	0.8 mm	0.3 mm	20.6 mm ± 1.2	Enclosure: PBT glass Lever: Stainless steel Roller: Brass(Ni plated)
KH-9012-5HLRC		150g	4.0 mm	1.6 mm	0.6 mm	18.3 mm ± 1.6	Enclosure: PBT glass Lever: Stainless steel
KH-9012-5PBFC		250g	1.6 mm	0.8 mm	0.3 mm	14.7 mm ± 0.7	Enclosure: PBTglass

CONTROL  
COMPONENTS

MICRO  
SWITCH









FOOT  
SWITCH

LIMIT  
SWITCH

POWER  
SWITCH

HOIST  
SWITCH

CAM  
SWITCH

Model	Model	OF Max.	PT Max	MD Max.	OT min.	OP	Material
KH-9012-PBC		500g	1.6 mm	1.0 mm	0.3 mm	14.7 mm $\pm$ 0.7	Enclosure: PBT glass
KH-9012-HLC		600g	1.6 mm	1.5 mm	0.3 mm	15.3 mm $\pm$ 0.6	Enclosure: PBT glass Lever: Stainless steel
KH-9012-HLLC		300g	4.0 mm	3.0 mm	0.6 mm	15.3 mm $\pm$ 1.6	Enclosure: PBT glass Lever: Stainless steel
KH-9012-HRLC		300g	4.0 mm	3.0 mm	0.6 mm	20.7 mm $\pm$ 1.6	Enclosure: PBT glass Lever: Stainless steel Roller: Brass(Ni plated)
KH-9012-HRMC		400g	4.0 mm	3.0 mm	0.6 mm	20.6 mm $\pm$ 1.6	Enclosure: PBT glass Lever: Stainless steel Roller: Brass(Ni plated)
KH-9012-HRSC		600g	1.6 mm	1.5 mm	0.3 mm	20.6 mm $\pm$ 1.0	Enclosure: PBT glass Lever: Stainless steel Roller: Brass(Ni plated)
KH-9012-HLRC		300g	4.0 mm	3.0 mm	0.6 mm	18.3 mm $\pm$ 1.6	Enclosure: PBT glass Lever: Stainless steel
KH-9012-PBFC		500g	1.6 mm	1.0 mm	0.3 mm	14.7 mm $\pm$ 0.7	Enclosure: PBT glass

Reference

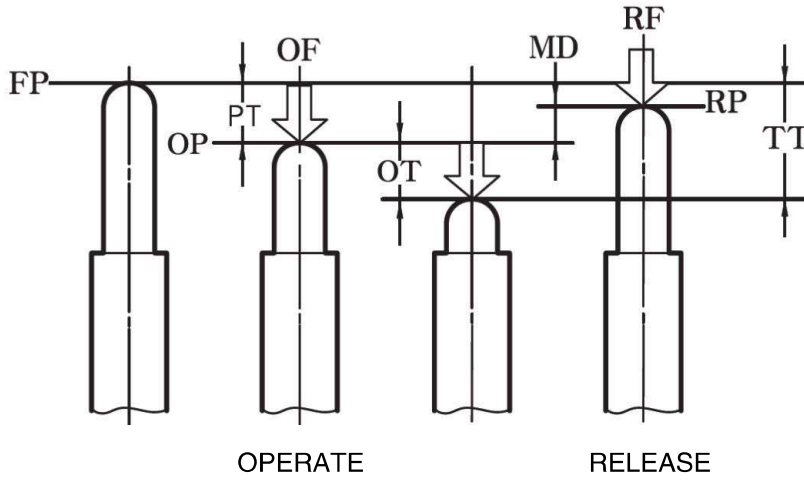

OF	Required force to actuate	Required force to move from free position (FP) to operating position (OP)
RF	Return force	Required force to return from total travel position (TTP) to return position (RP)
PT	Movement to actuation	Distance or angle of movement from free position (FP) to operating position (OP)
MD	Movement differential	Distance or angle of movement from operating position (OP) to return position (RP)
OT	Movement after actuation	Distance or angle of movement from operating position (OP) to total travel position (TTP)
OP	Operating position	Actuator position when a contact point (NO (normal open)) is actuated (On) at free position (FP).
FP	Free position	Actuator position when no external force is applied to actuator
TTP	Total travel position	Actuator position when actuator arrives at stop.
RP	Return position	Actuator when a contact point (NO) is off at operating position (OP).
TT	Entire movement	Distance or angle of movement from free position (FP) to total travel position (TTP).

CONTROL COMPONENTS

MICRO SWITCH

FOOT SWITCH

LIMIT SWITCH

POWER SWITCH

HOIST SWITCH

CAM SWITCH

**Dimension**

V2F1P01C (KH-9012-5PB(C))

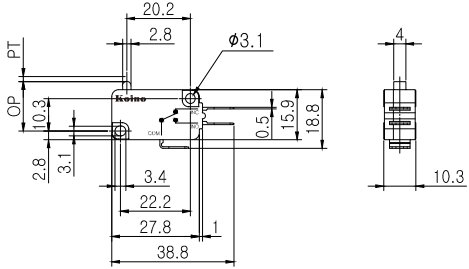

V2F1L05C (KH-9012-5HL(C))

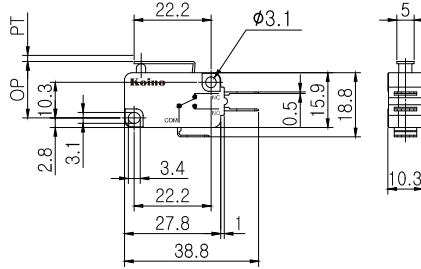

V2F1L01C (KH-9012-5HL(L)C)

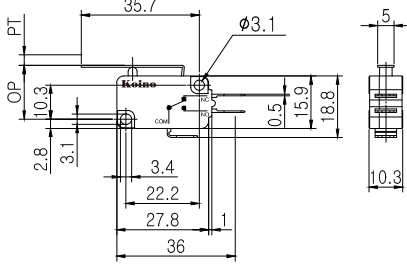

V2F1L01(R)C (KH-9012-5HL(R)C)

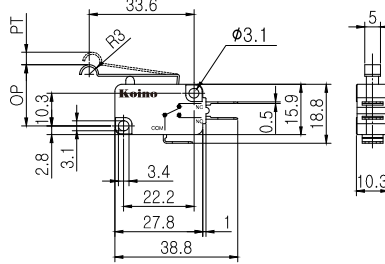

V2F1L04C (KH-9012-5HR(M)C)

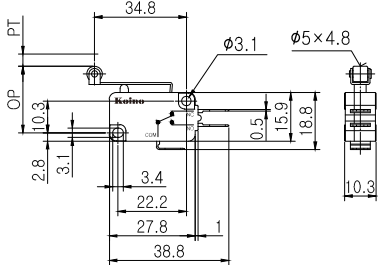

V2F1L07C (KH-9012-5HR(S)C)

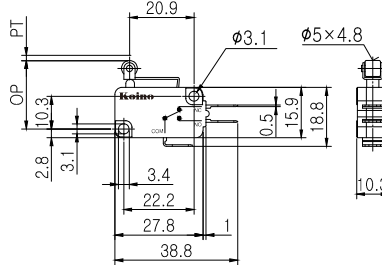

V2F1P01C (KH-9012-5PB(F)C)

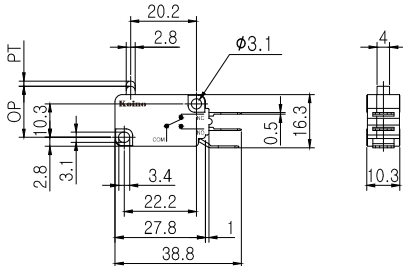

V2F1L03C (KH-9012-5HR(L)C)

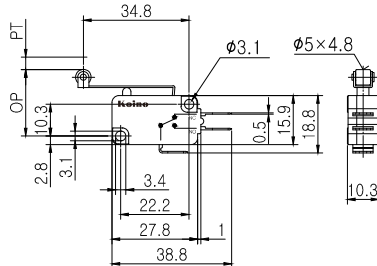

Dimension

V4F1P01C (KH-9012-PB(C))

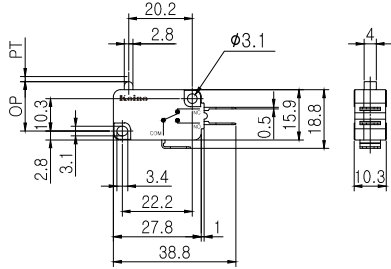

V4F1L05C (KH-9012-HL(C))

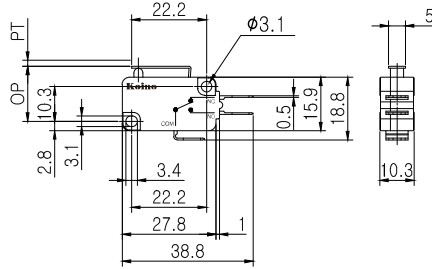

V4F1L01C (KH-9012-HL(L)C)

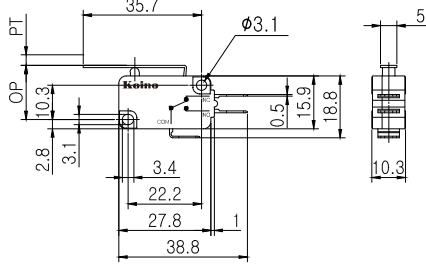

V4F1L03C (KH-9012-HR(L)C)

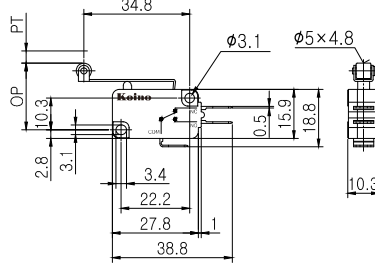

V4F1L04C (KH-9012-HR(M)C)

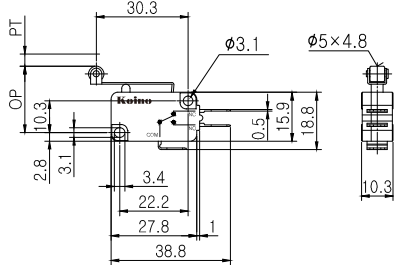

V4F1L07C (KH-9012-HR(S)C)

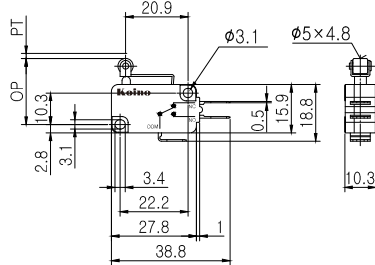

V4F1P01C (KH-9012-PB(F)C)

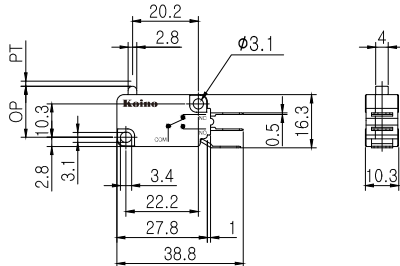

V4F1L01(R)C (KH-9012-HL(R)C)

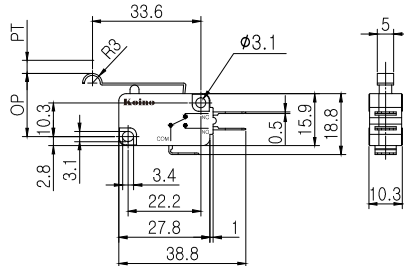

CONTROL COMPONENTS

MICRO SWITCH

FOOT SWITCH

LIMIT SWITCH

POWER SWITCH

HOIST SWITCH

CAM SWITCH

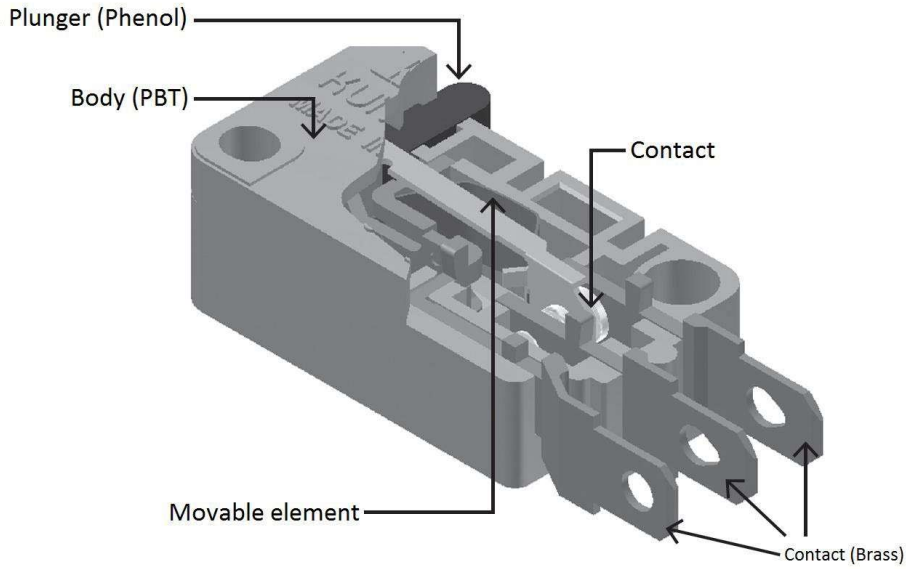

## Technical Information

Allowed Operating Velocity		0.1 m m/s ~ 1 m m/s
Operating Frequency	Mechanical	240 operations/minute
Operating Frequency	Electrical	20 operations/minute
Insulation Resistance		100 MΩ min. (DC 500V)
Contact Resistance		15 mΩ Max.
Dielectric Strength	Between live parts	1,000VAC (50/60Hz) for 1 minute
	Between dead parts	1,500VAC (50/60Hz) for 1 minute
Vibration Resistance	Malfunction	10 ~ 55Hz double amplitude 1.5 m m, X, Y, Z at each direction
Shock Resistance	Destruction	100 G
	Malfunction	5 G
Durability	Mechanical	1,000,000 operations
	Electrical	100,000 operations
Protection		IP40
Ambient Temperature		-25 ~ +80°C (not freezing condition)
Ambient Humidity		45 ~ 85 % RH
Weight		6.2 ~ 10.5 g